

# FULL SIZED RAISED BED FRAME

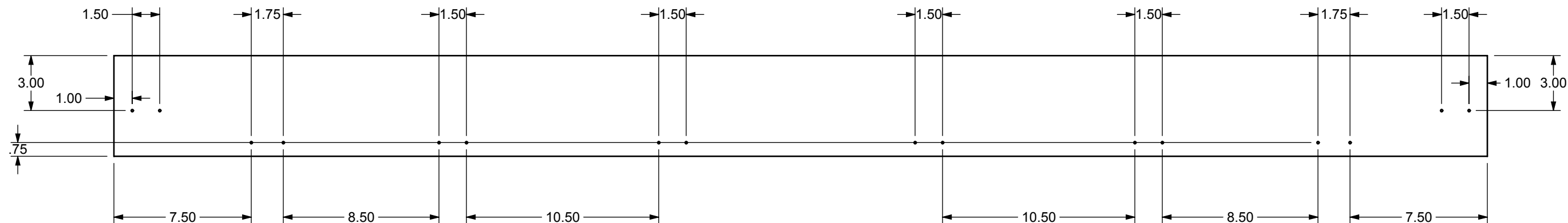

PRE-DRILLING PLANS  
ALL HOLES TO BE DRILLED AT 1/8"



75" 2X6

2 TOTAL

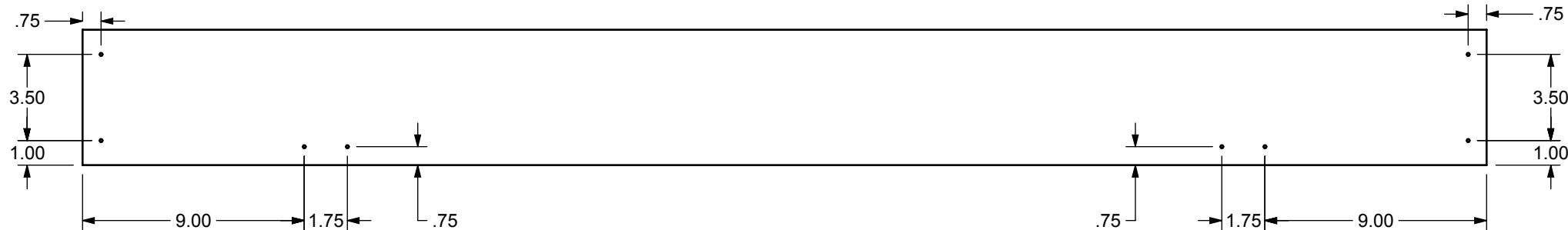

57" 2X6

2 TOTAL

PRE-DRILLING PLANS  
ALL HOLES TO BE DRILLED AT 1/8"



54" 2X4  
SUPPORT BEAM  
4 TOTAL

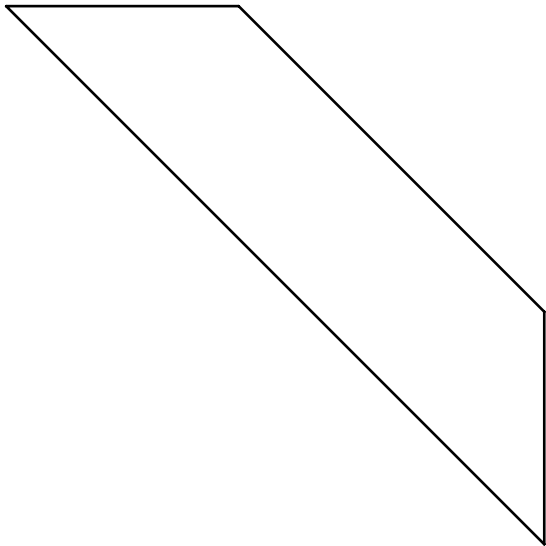
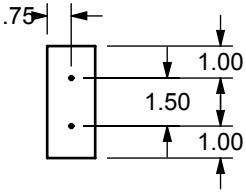

16" 2X4  
45 DEGREE ANGLE SUPPORT BEAM  
4 TOTAL

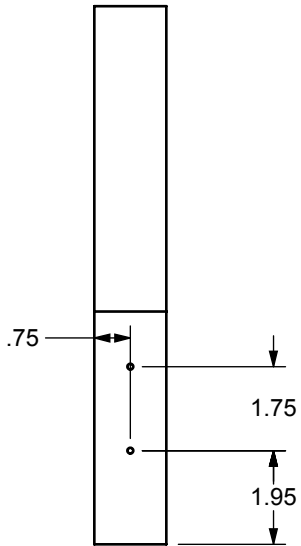

VIEW N-N  
SCALE 1 : 4

PRE-DRILLING PLANS  
ALL HOLES TO BE DRILLED AT 1/8"

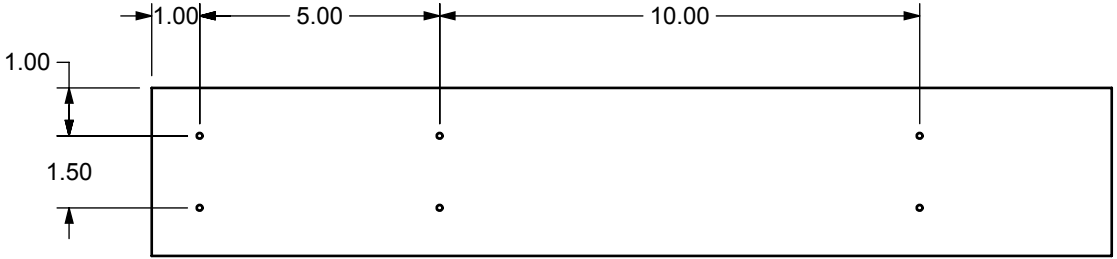

INSIDE SUPPORT

8 TOTAL

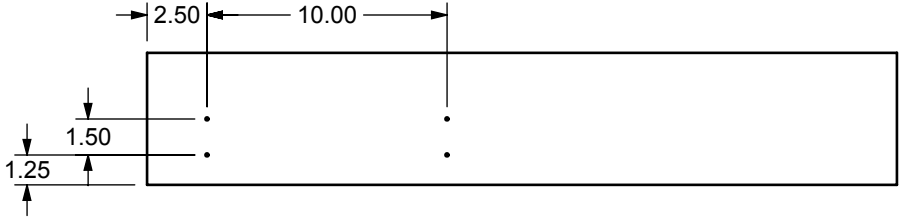
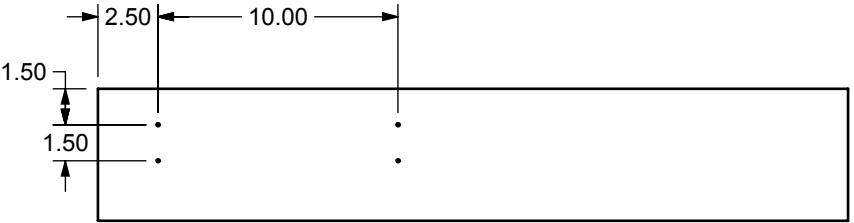

OUTSIDE LEGS

(THESE LEGS WILL BE THE FIRST ATTACHED ON EACH SIDE)

4 TOTAL

INSIDE LEGS

4 TOTAL

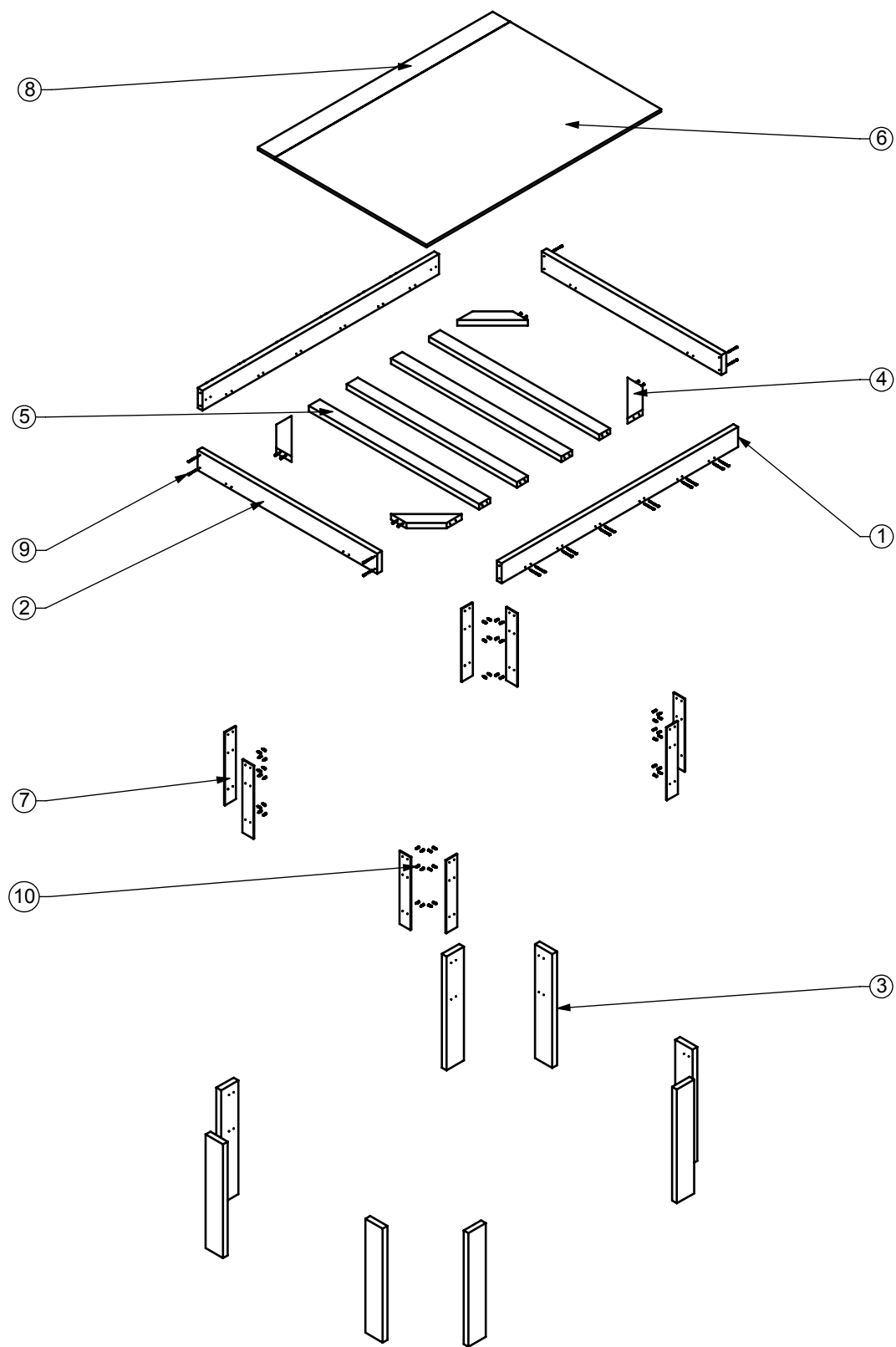

ITEM NO.	QTY.	PART NO.	DESCRIPTION
1	2	LONG SIDE OF BED FRAME	2" X 6" WOOD, 75" IN LENGTH;
2	2	SHORT SIDE OF BED FRAME	2" X 6" WOOD, 57" IN LENGTH;
3	8	LEG	2" X 6" WOOD, 31.25" LENGTH;
4	4	45 DEGREE ANGLE CUT SUPPORT PIECE	2" X 4" WOOD, 16" LENGTH WITH 45 DEGREE ANGLED CUTS;
5	4	SUPPORT BEAM	2" X 4" WOOD, 54" LENGTH;
6	1	PLYWOOD BASE LONG PIECE	3/4" PLYWOOD 48" X 74.5";
7	8	INSIDE BRACE	1/4" PLYWOOD, 20" LENGTH;
8	1	BASE PLATE FILLING	1" X 6" WOOD, 74.5" LENGTH;
9	40	#10 2.5" WOOD SCREW	#10 X 2.5" SCREW. PHLP, ZP
10	48	MMC#90031A247	#10 X 1" FH SM SCREW, PHLP, ZP

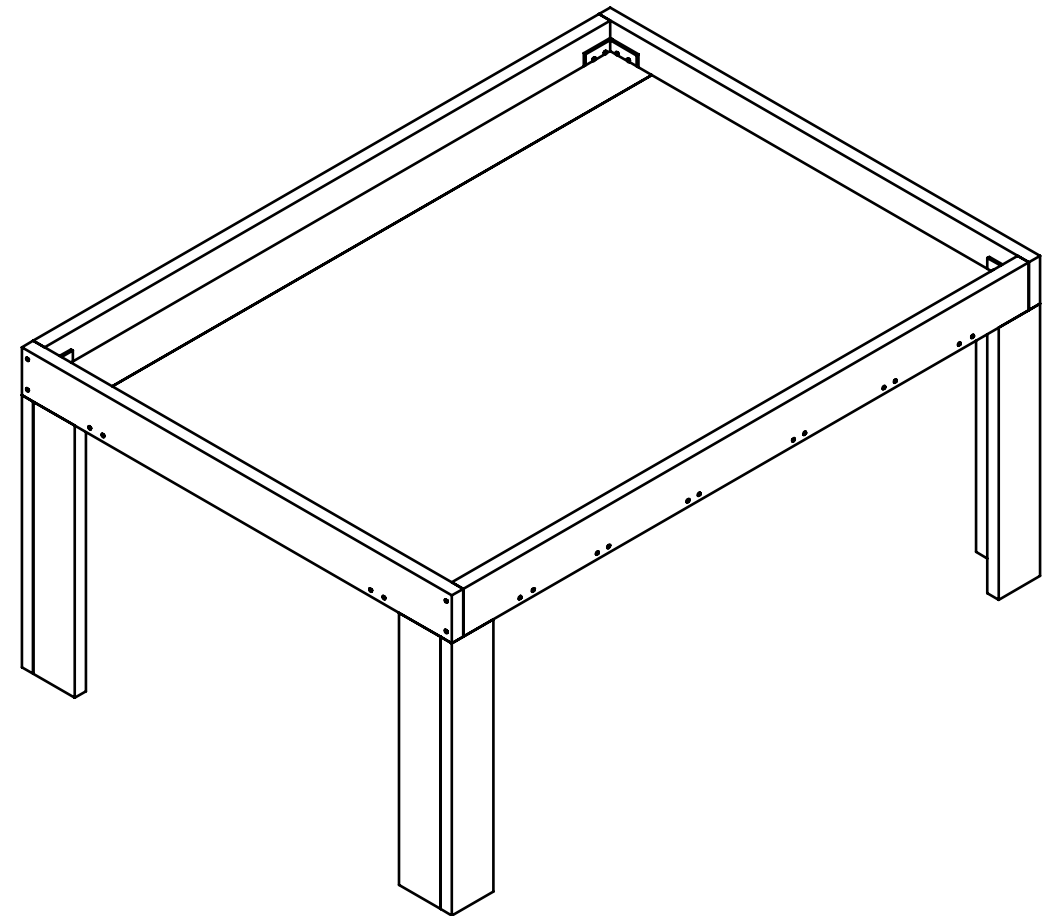

TOP VIEW

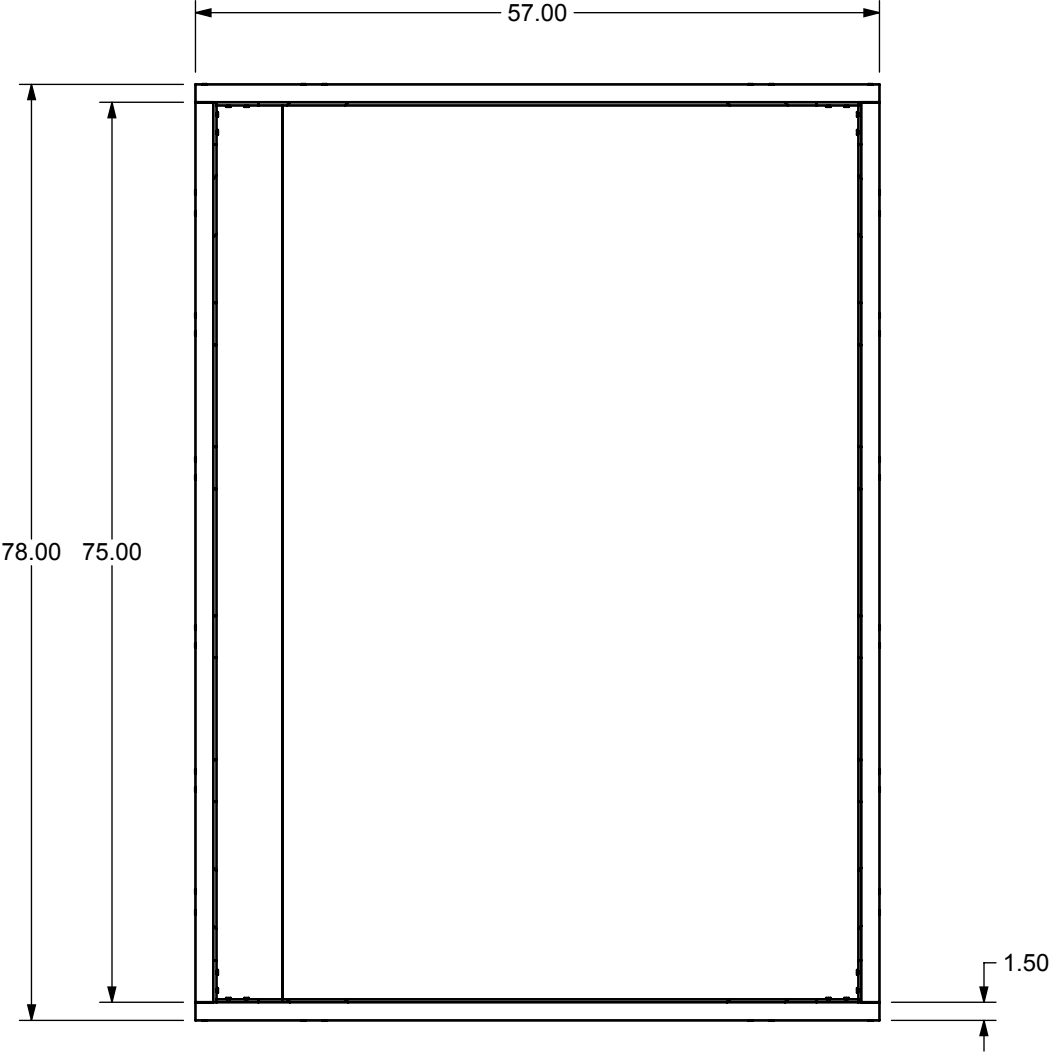

OVERALL DIMENSIONS

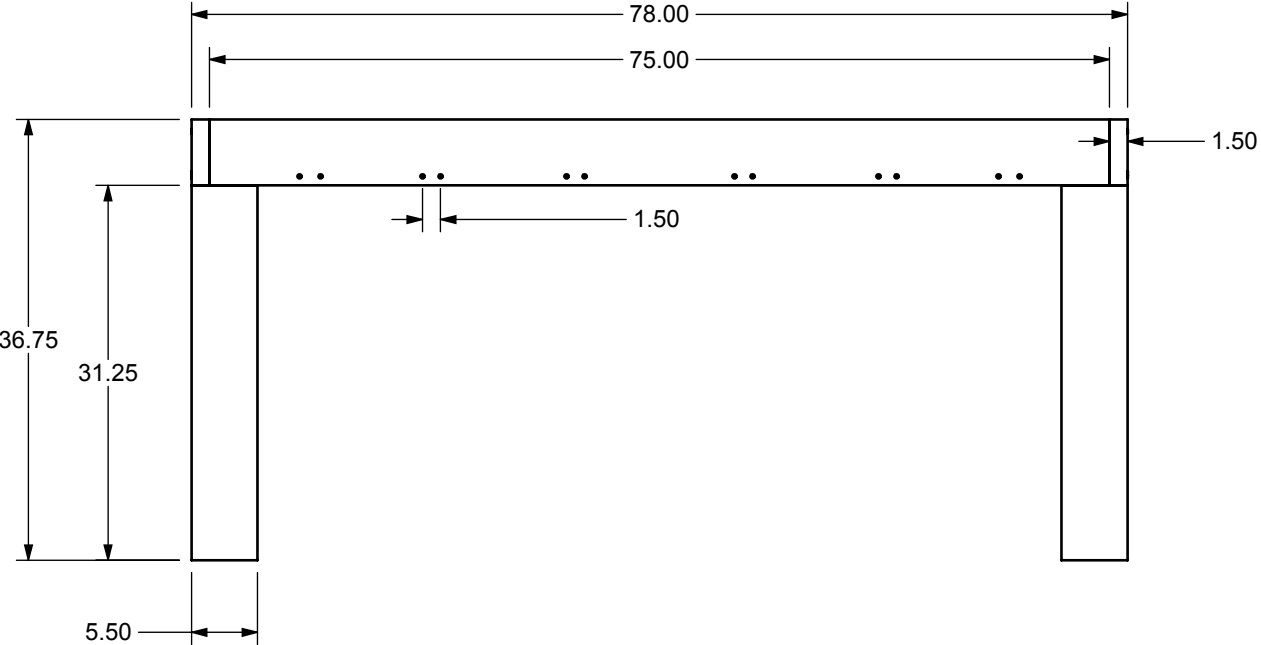

SIDE VIEW

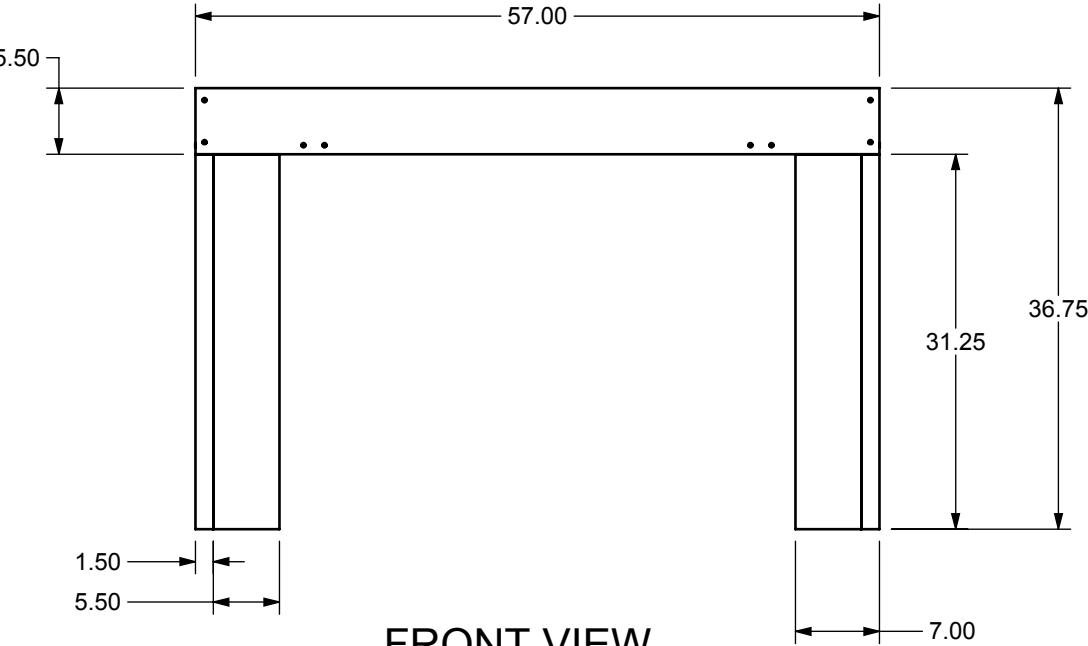

FRONT VIEW

MATERIALS FOR THIS STEP

STEP ONE: OUTSIDE FRAME

ITEM NO.	QTY.	PART NO.	DESCRIPTION
1	2	LONG SIDE OF BED FRAME	2" X 6" WOOD, 75" IN LENGTH;
2	2	SHORT SIDE OF BED FRAME	2" X 6" WOOD, 57" IN LENGTH;
9	8	#10 2.5" WOOD SCREW	#10 X 2.5" SCREW. PHLP, ZP

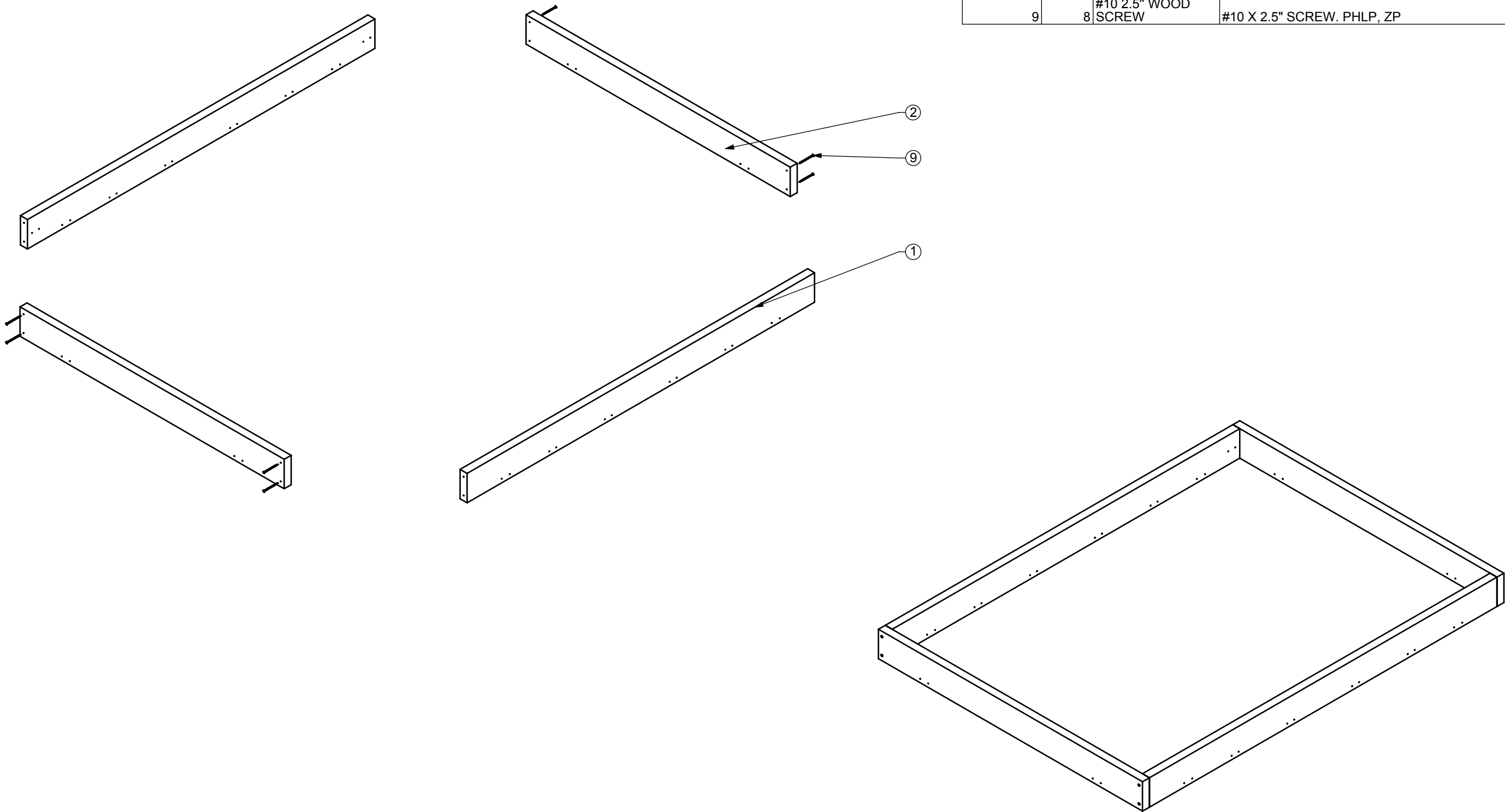

## STEP ONE: OUTSIDE FRAME

- USE TWO 2.5" WOOD SCREWS TO ATTACH THE 75" LONG PIECE TO THE 57" SHORT PIECE.
- THE PIECES SHOULD FORM A 90 DEGREE ANGLE
- THE LOCATION OF THE SCREWS IS SHOWN BELOW

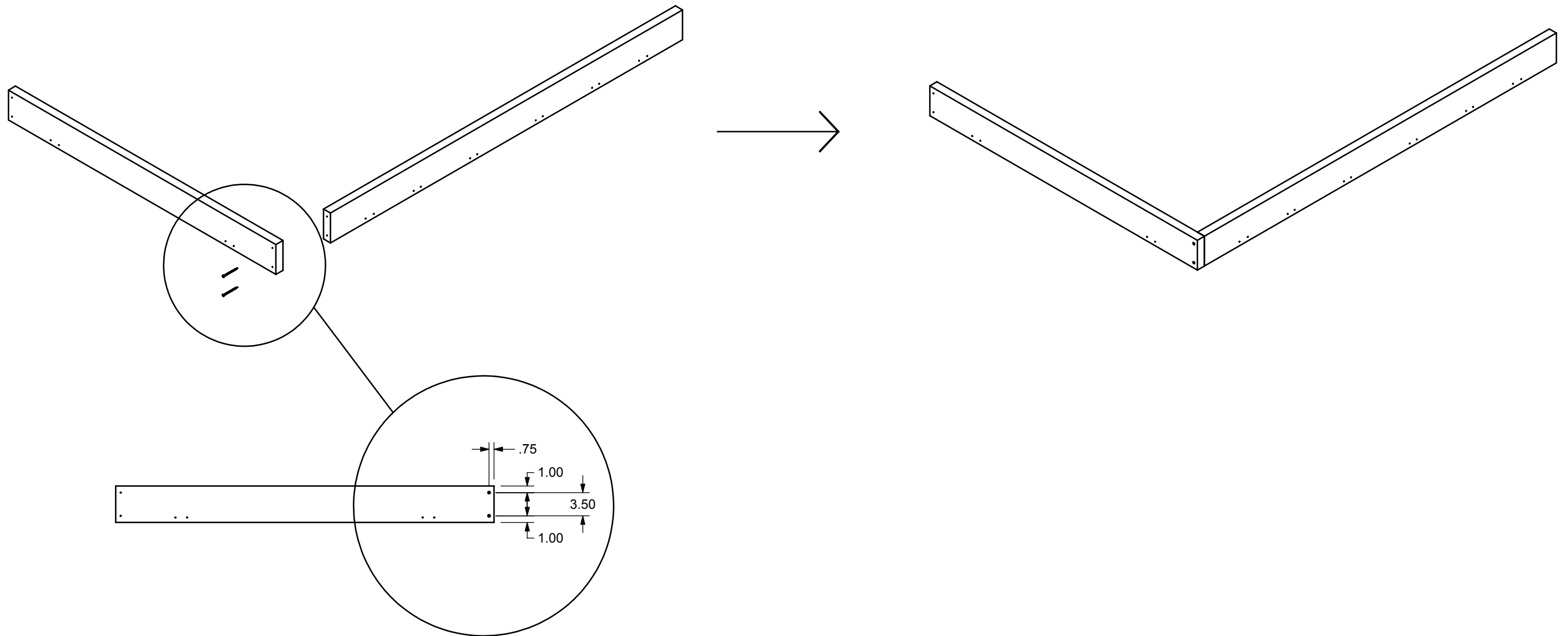



## STEP ONE: OUTSIDE FRAME

- USE TWO 2.5" WOOD SCREWS TO ATTACH THE SECOND 75" LONG PIECE TO THE 57" SHORT PIECE.
- THE PIECES SHOULD FORM A 90 DEGREE ANGLE
- THE LOCATIONS OF THE SCREWS REMAIN THE SAME AS THE PREVIOUS PAGE

- USE FOUR 2.5" WOOD SCREWS TO ATTACH THE SECOND 57" SHORT PIECE TO THE EXISTING ASSEMBLY
- THE LOCATIONS OF THE SCREWS REMAIN THE SAME AS THE PREVIOUS PAGE

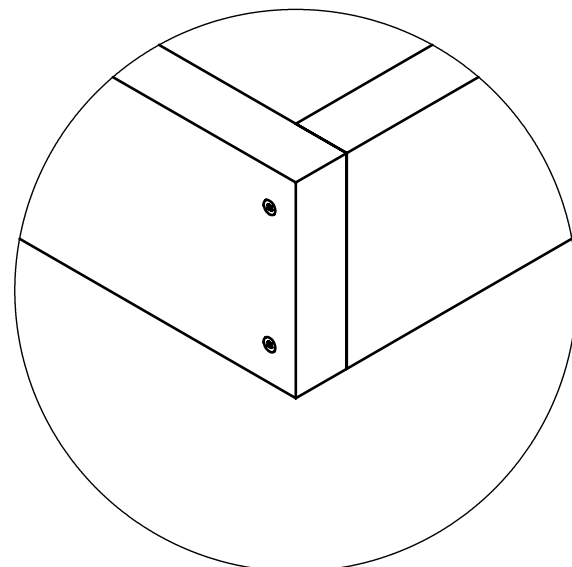
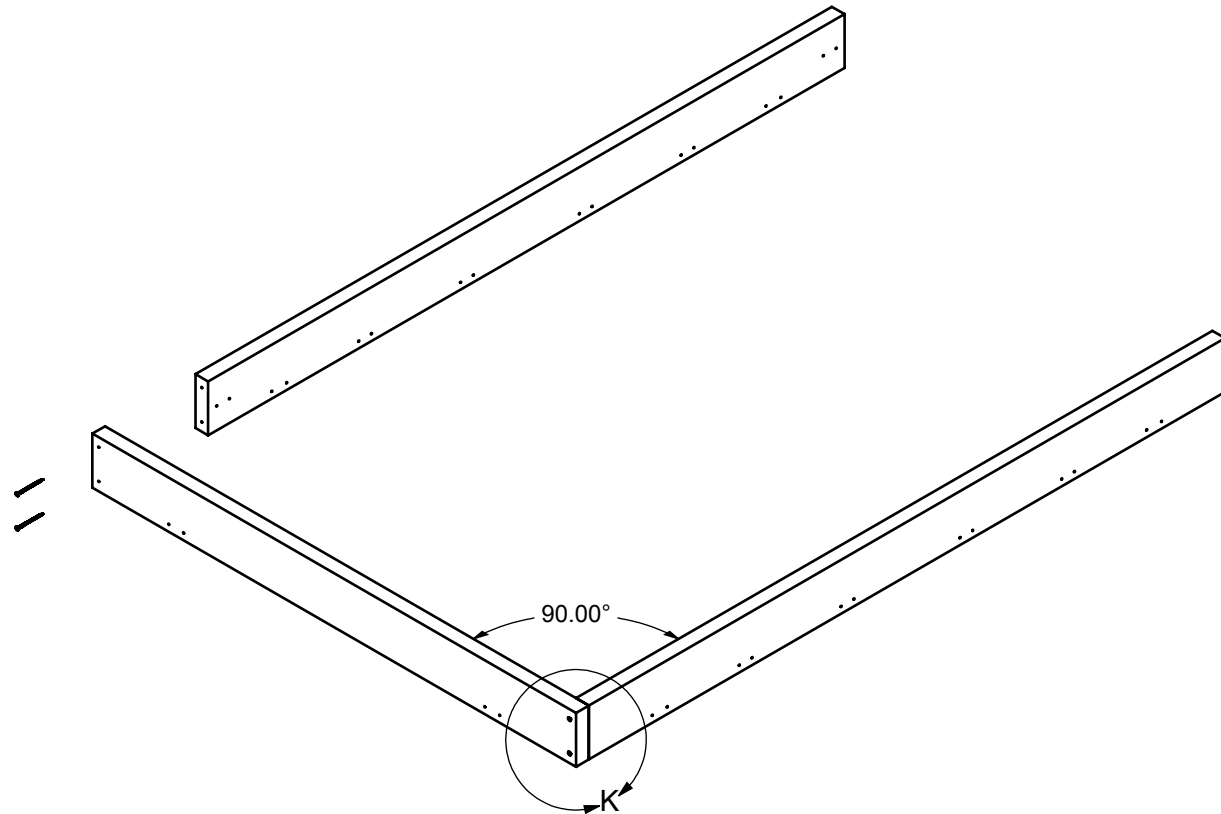

DETAIL K  
SCALE 1 : 4

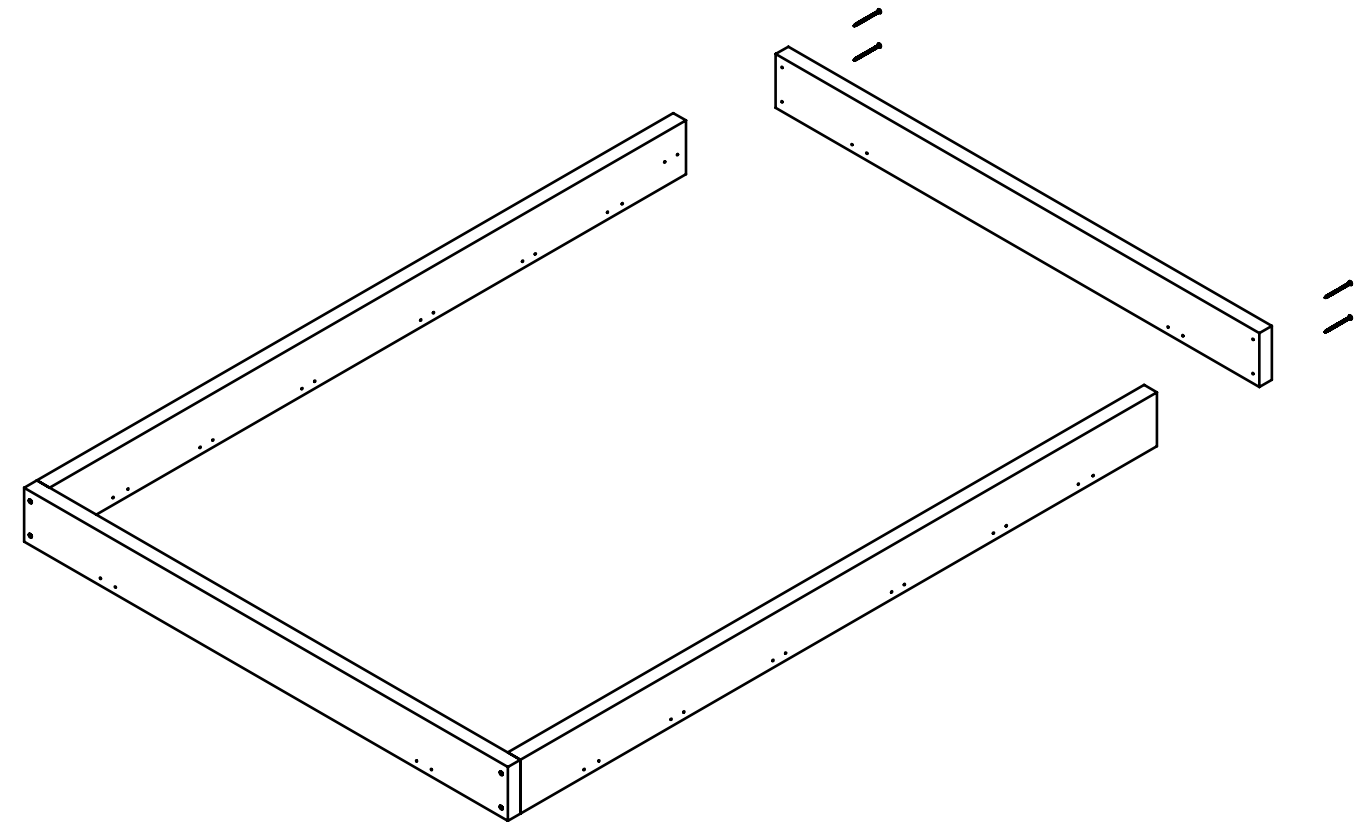

**NOTE:** THE SHORTER SIDE PIECES SANDWICH THE LONGER PIECES- THE LONG PIECES SHOULD BE FLUSH WITH THE SIDES OF THE SHORTER PIECES.

STEP TWO: OUTSIDE FRAME SUPPORTS

MATERIALS FOR THIS STEP

ITEM NO.	QTY.	PART NO.	DESCRIPTION
4	4	45 DEGREE ANGLE CUT SUPPORT PIECE	2" X 4" WOOD, 16" LENGTH WITH 45 DEGREE ANGLED CUTS;
5	4	SUPPORT BEAM	2" X 4" WOOD, 54" LENGTH;
9	32	#10 2.5" WOOD SCREW	#10 X 2.5" SCREW. PHLP, ZP

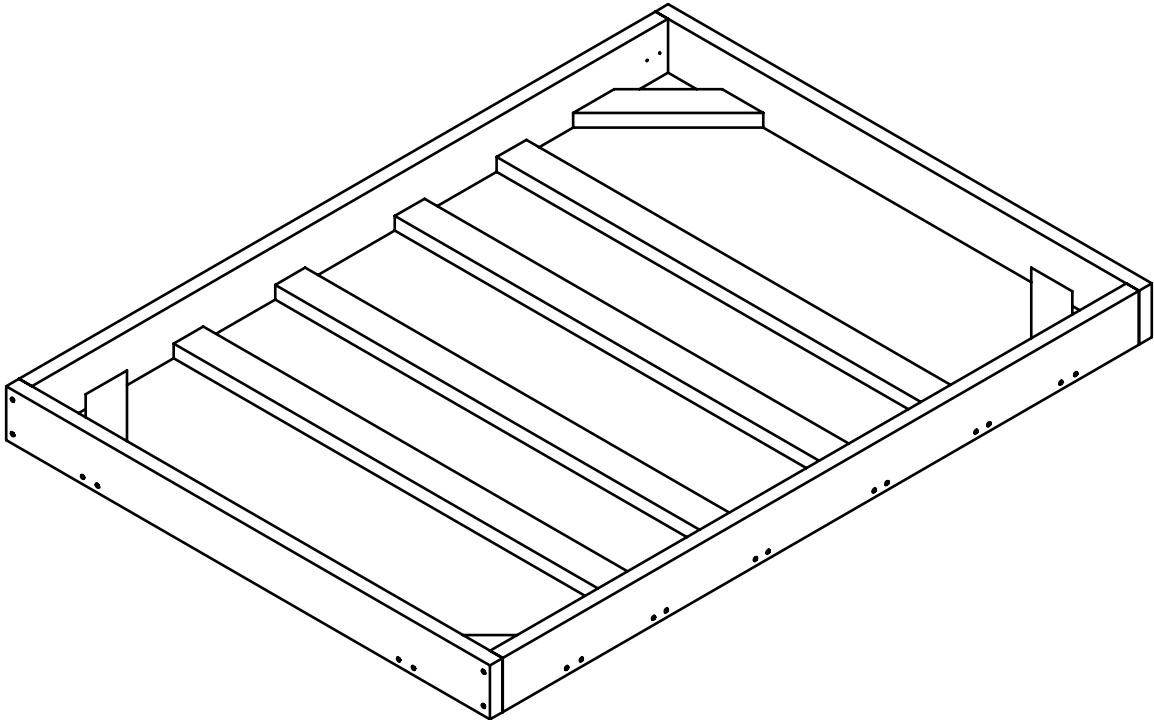
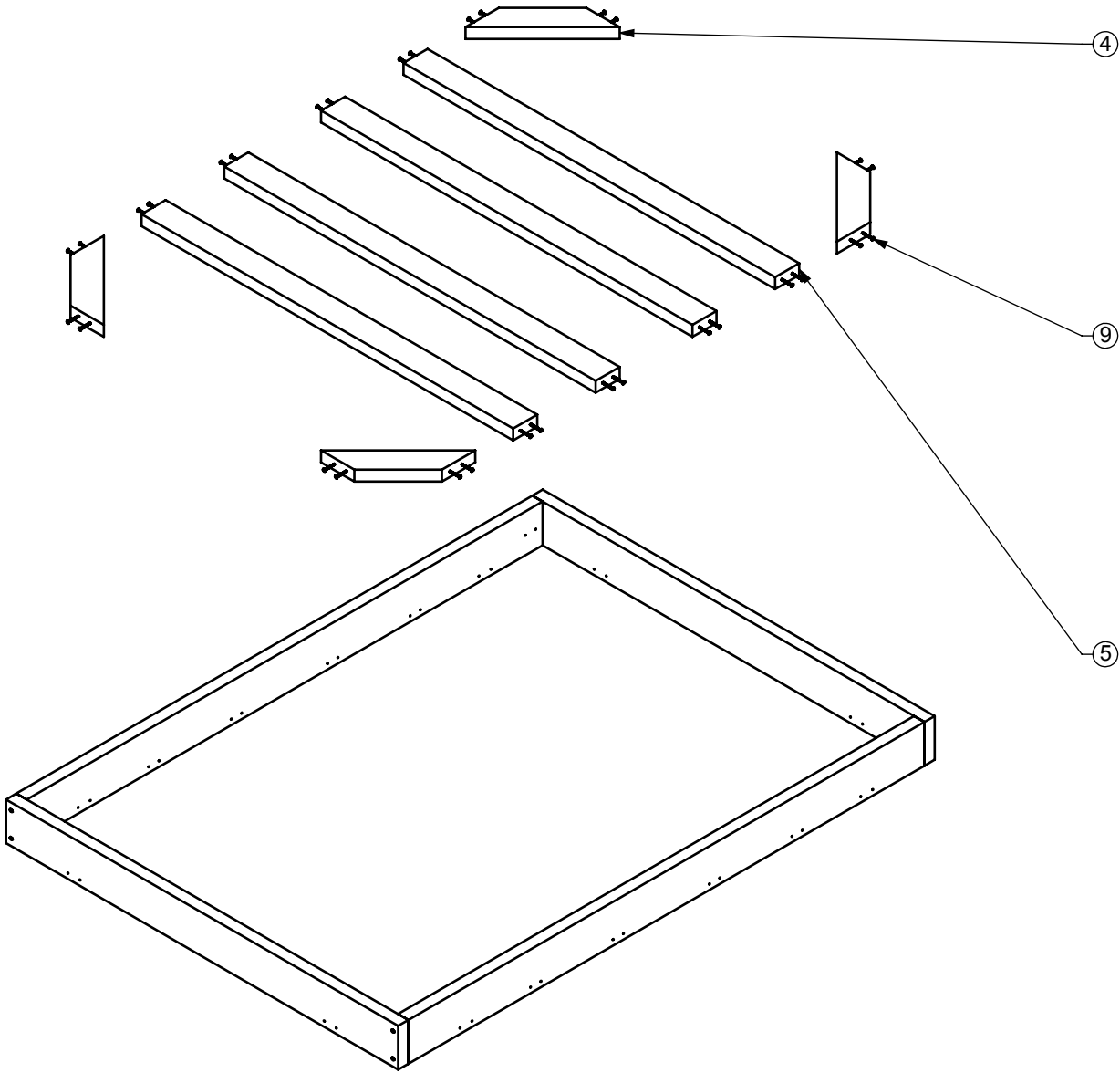

## STEP TWO: OUTSIDE FRAME SUPPORTS

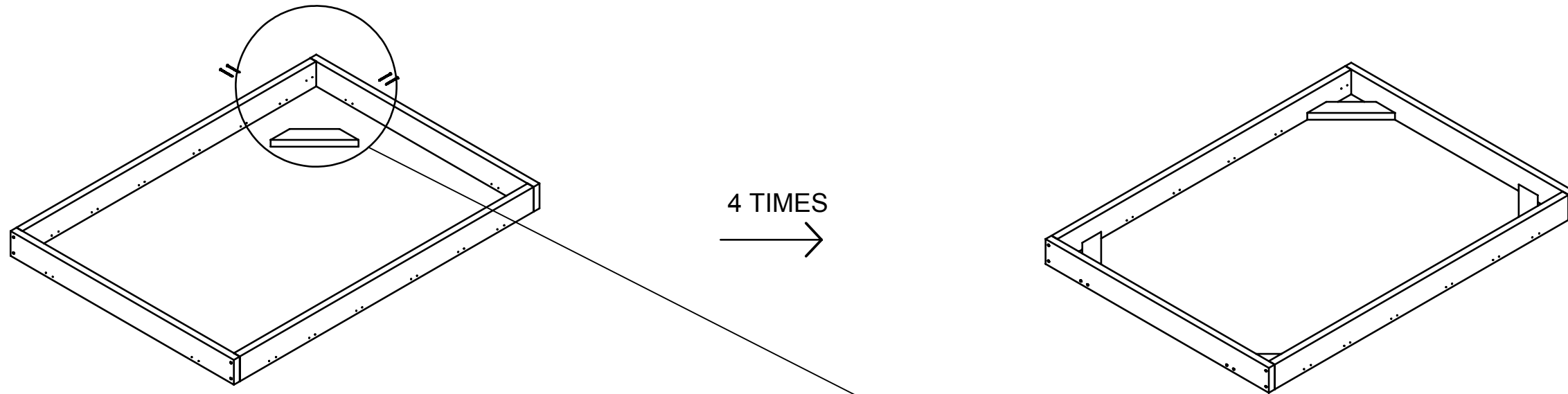

- USE TWO 2.5" WOOD SCREWS TO ATTACH THE 45 DEGREE ANGLED PIECES FLUSH INSIDE THE CORNER OF THE EXISTING FRAME
- THE ANGLED PIECE SHOULD HAVE ITS BOTTOM FACE FLUSH WITH THE BOTTOM OF THE EXISTING FRAME (PLACE ASSEMBLY ON THE GROUND TO ENSURE LEVEL ATTACHMENT)
- THE LOCATION OF THE SCREWS IS SHOWN HERE
- **REPEAT FOR ALL FOUR CORNERS**

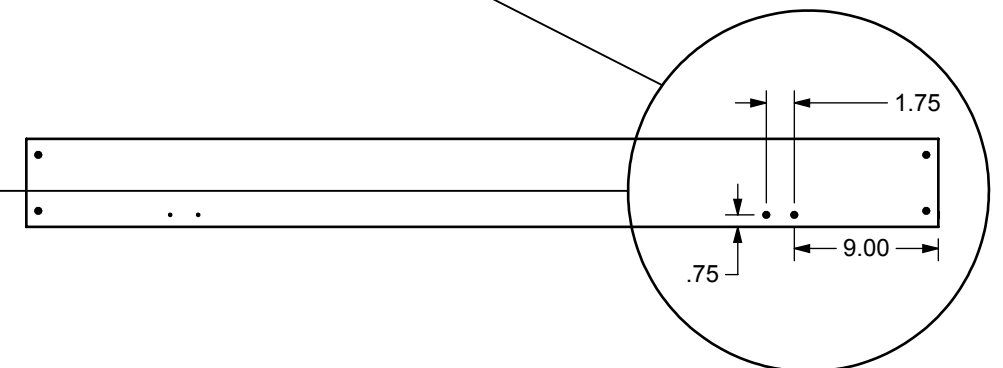

- **NOTE:** DIMENSIONS GIVEN FOR REFERENCE - NOT NECESSARY TO BE EXACT

STEP TWO: OUTSIDE FRAME SUPPORTS

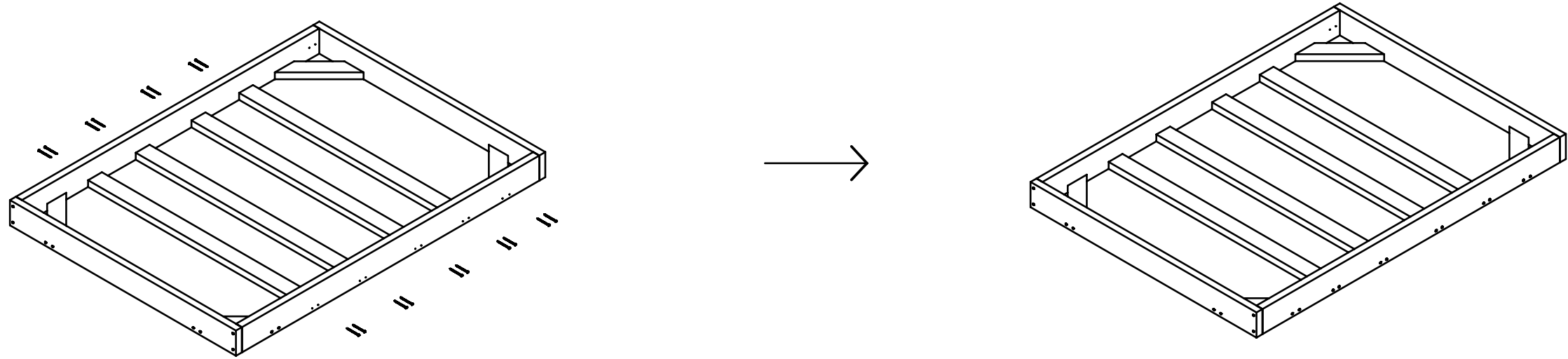

- USE FOUR 2.5" WOOD SCREWS TO ATTACH EACH OF THE 54" SUPPORT BEAMS DRILLING FROM THE OUTSIDE OF THE FRAME
- THE BOTTOM FACE OF EACH PIECE SHOULD BE FLUSH WITH THE BOTTOM OF THE FRAME (PLACING THE ASSEMBLY ON THE GROUND WHILE DRILLING WILL ENSURE THIS)
- 
- THE LOCATIONS OF THE SCREWS ARE SHOWN BELOW

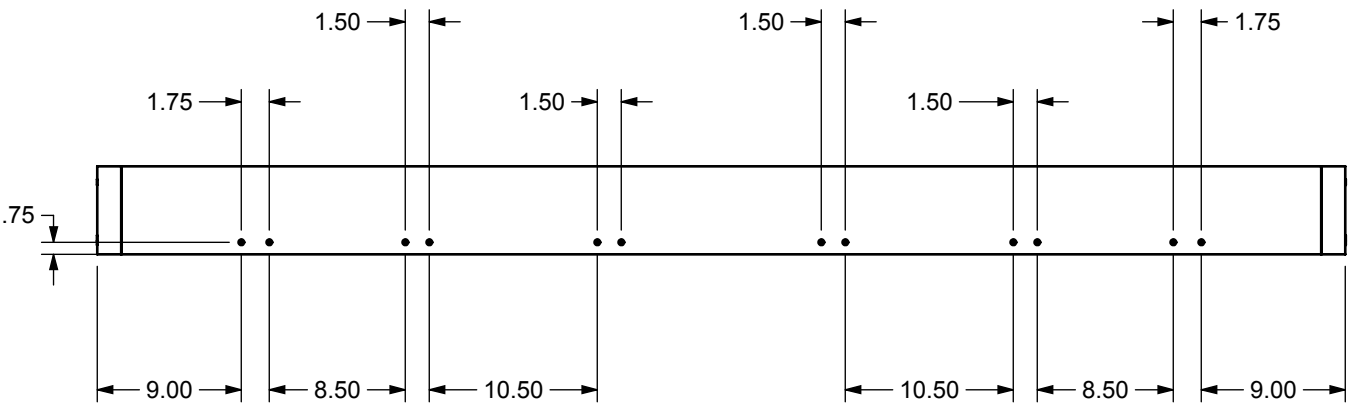

SIDE VIEW

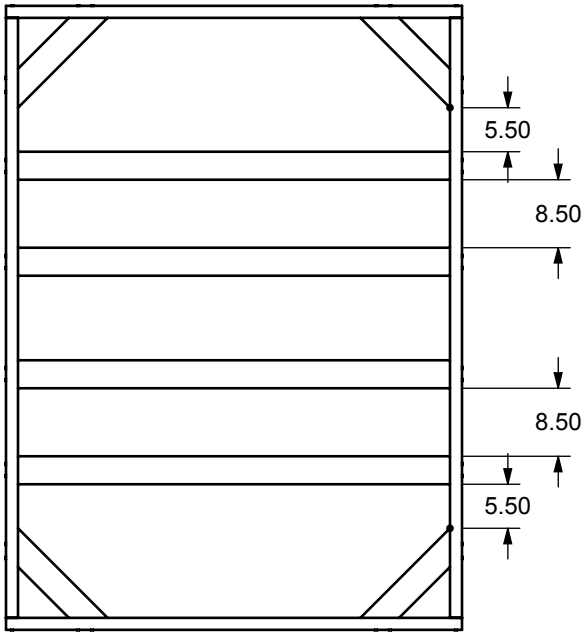

TOP VIEW

**NOTE: THE GIVEN DIMENSIONS DO NOT NEED TO BE EXACT - THE 4 SUPPORT BEAMS NEED TO BE EVENLY SPACED IN BETWEEN THE 45 DEGREE ANGLED PIECES. TWO 2.5" SCREWS SHOULD FASTEN THE BEAM ON EACH SIDE OF THE ASSEMBLY. FOLLOWING THE PROVIDED DIMENSIONS CLOSELY WILL PROVIDE STABILITY**

STEP THREE: INTERIOR LEG ATTACHMENTS

MATERIALS FOR THIS STEP

ITEM NO.	QTY.	PART NO.	DESCRIPTION
7	8	INSIDE BRACE	1/4" PLYWOOD, 20" LENGTH;
10	16	MMC#90031A247	#10 X 1" FH SM SCREW, PHLP, ZP

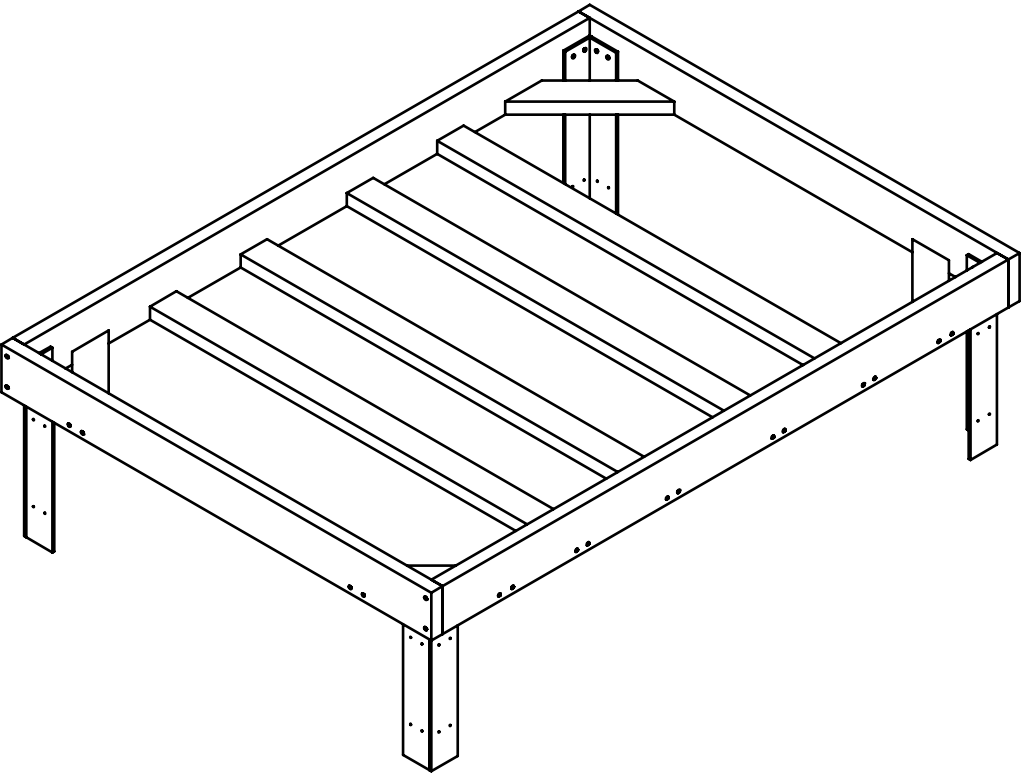
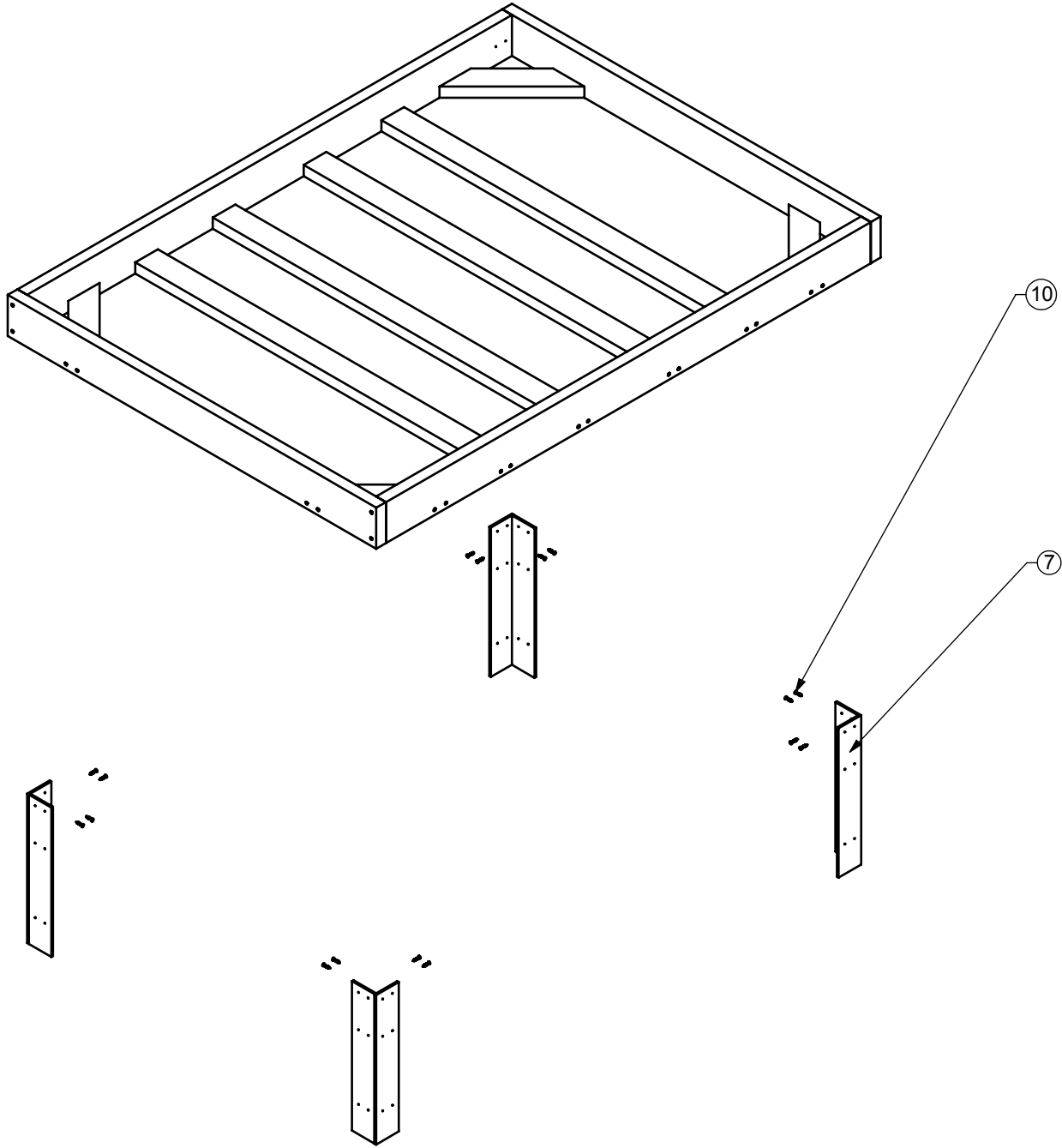

## STEP THREE: INTERIOR LEG ATTACHMENTS

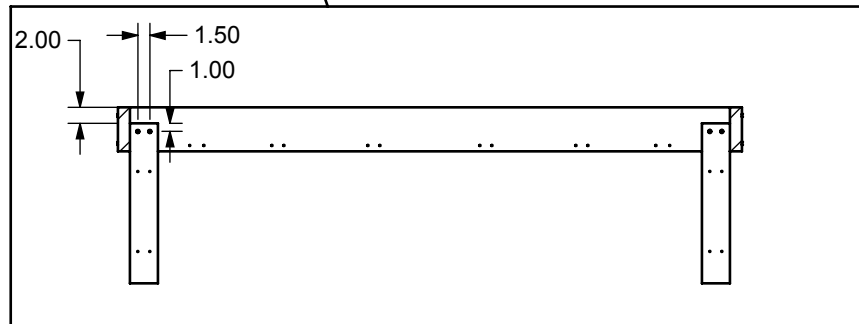
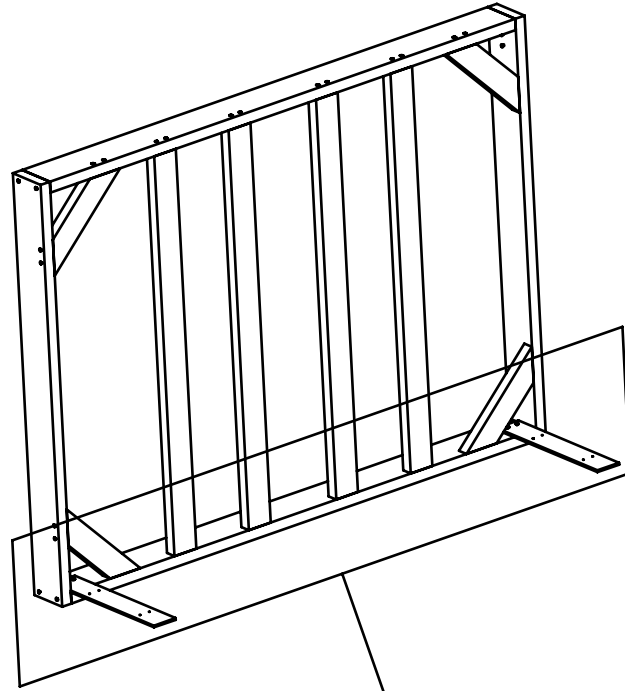

- PLACE THE ASSEMBLY ON ITS SIDE IN ORDER TO ATTACH INNER LEGS
- USE TWO 2.5" WOOD SCREWS PER LEG TO ATTACH THE INNER LEG PIECES
- THE LOCATIONS OF THE SCREWS ARE SHOWN ABOVE
- THE SIDES OF THE INNER LEGS SHOULD BE FLUSH UP AGAINST THE INSIDE OF THE EXISTING ASSEMBLY (SEE BELOW FOR DETAIL)

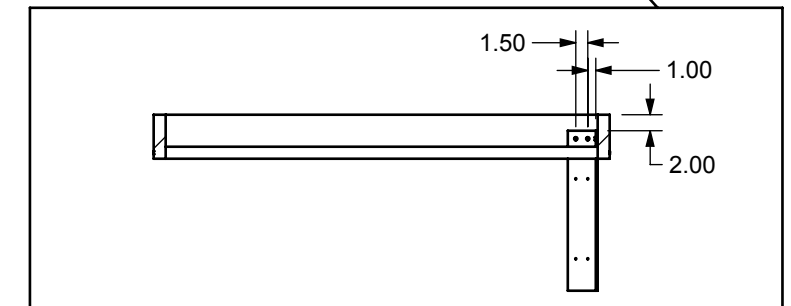
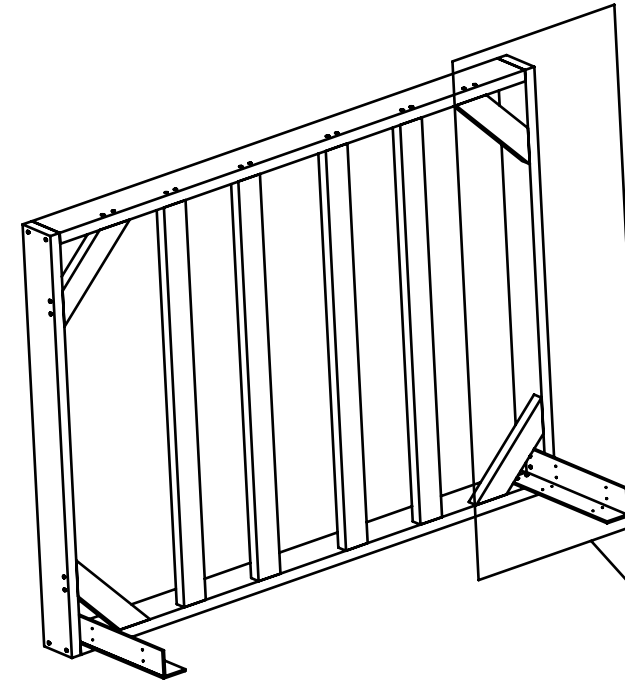

- KEEP THE ASSEMBLY ON ITS SIDE IN ORDER TO ATTACH INNER LEGS
- USE TWO 2.5" WOOD SCREWS PER LEG TO ATTACH THE SECOND INNER LEG PIECES
- THE LOCATIONS OF THE SCREWS ARE SHOWN BELOW
- THE SIDES OF THE INNER LEGS SHOULD BE FLUSH UP AGAINST THE INSIDE OF THE EXISTING ASSEMBLY (SEE BELOW FOR DETAIL)

**NOTE: REPEAT ON OPPOSITE  
SIDE IN SAME MANNER**

STEP FOUR: EXTERIOR LEG ATTACHMENTS

MATERIALS FOR THIS STEP

ITEM NO.	QTY.	PART NO.	DESCRIPTION
3	8	LEG	2" X 6" WOOD, 31.25" LENGTH;
6	1	PLYWOOD BASE LONG PIECE	3/4" PLYWOOD 48" X 74.5";
8	1	BASE PLATE FILLING	1" X 6" WOOD, 74.5" LENGTH;
10	32	MMC#90031A247	#10 X 1" FH SM SCREW, PHLP, ZP

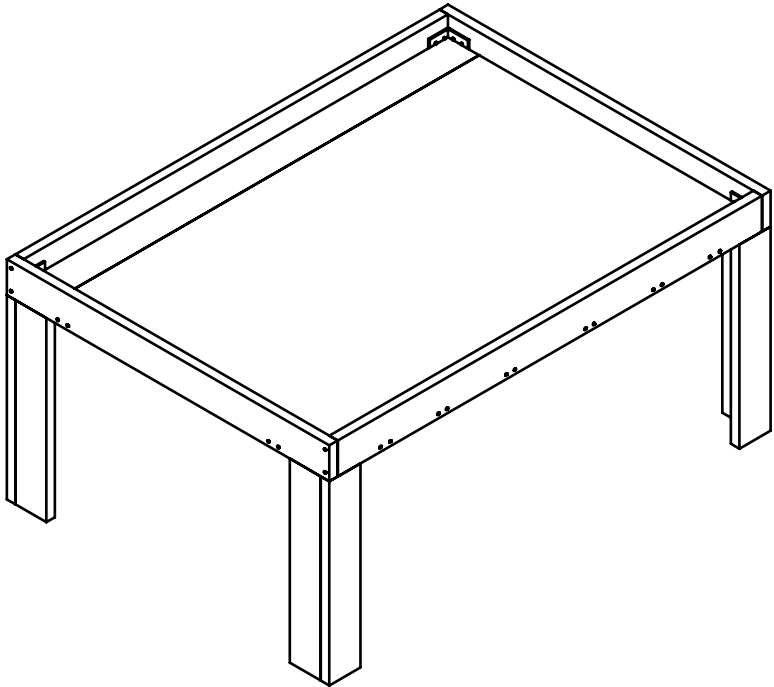
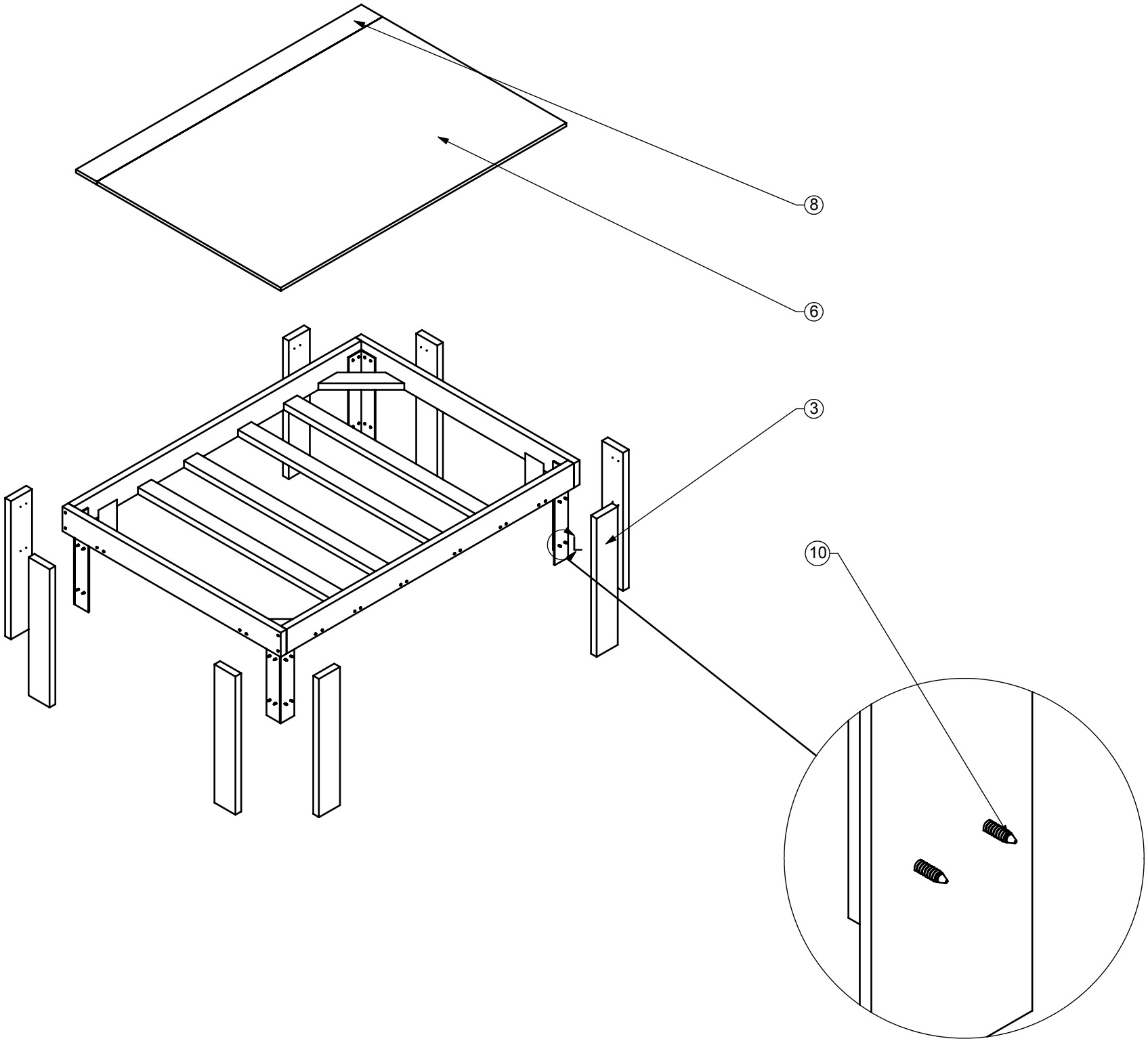

# STEP FOUR: EXTERIOR LEG ATTACHMENTS

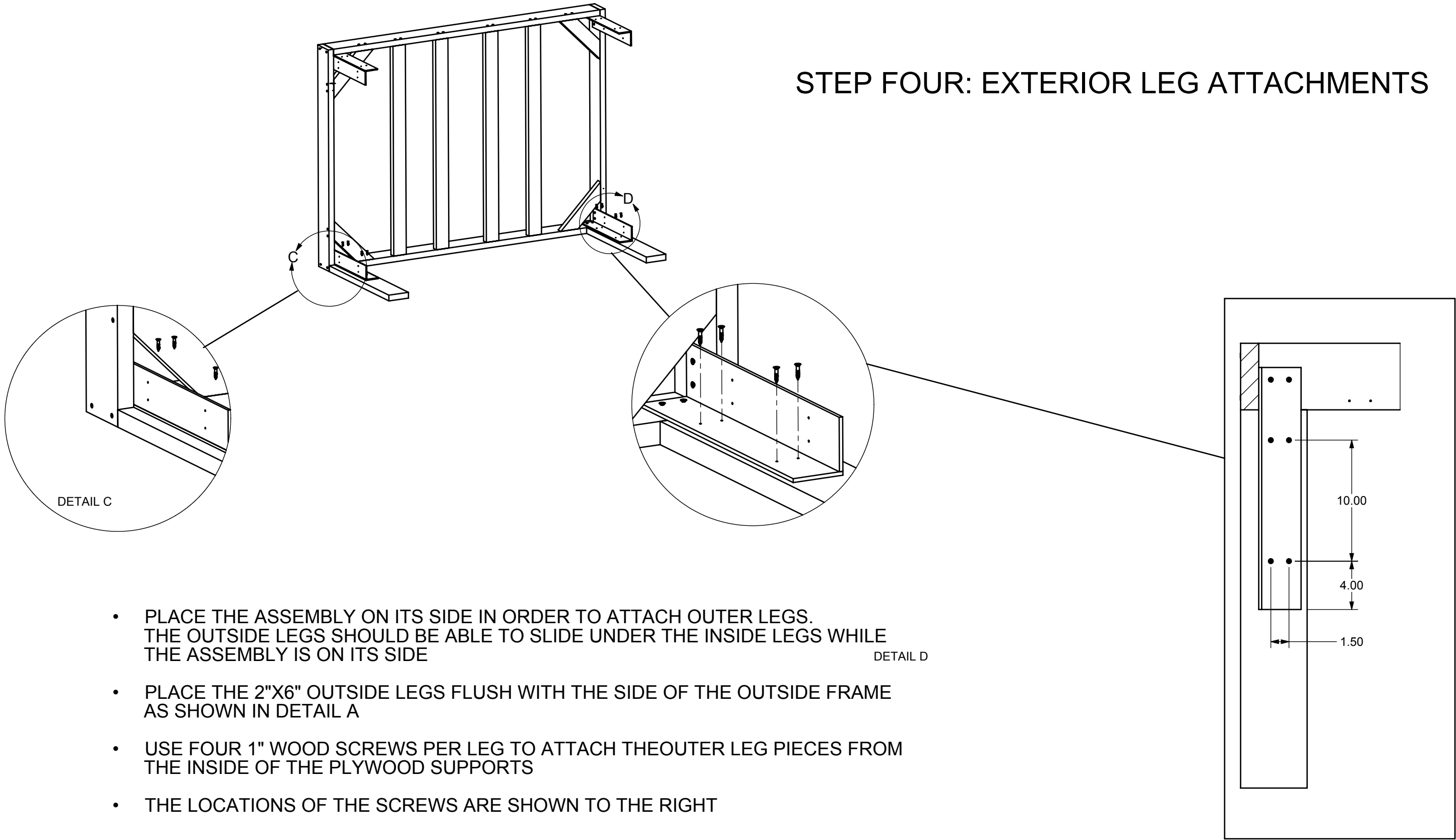

**NOTE: FLIP OVER AND REPEAT STEPS FOR SECOND SIDE**



# STEP FOUR: EXTERIOR LEG ATTACHMENTS

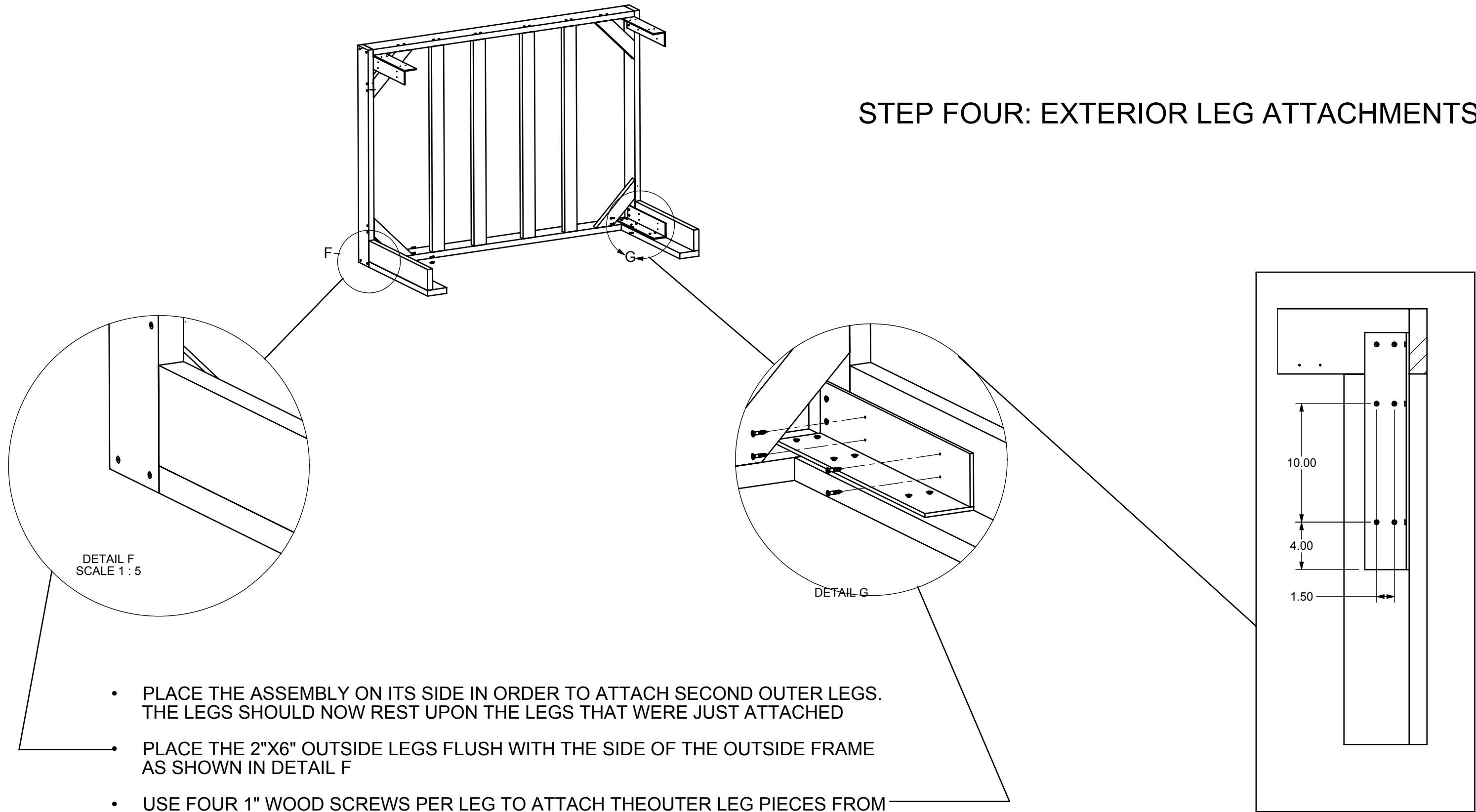

- PLACE THE ASSEMBLY ON ITS SIDE IN ORDER TO ATTACH SECOND OUTER LEGS. THE LEGS SHOULD NOW REST UPON THE LEGS THAT WERE JUST ATTACHED
- PLACE THE 2"X6" OUTSIDE LEGS FLUSH WITH THE SIDE OF THE OUTSIDE FRAME AS SHOWN IN DETAIL F
- USE FOUR 1" WOOD SCREWS PER LEG TO ATTACH THE OUTER LEG PIECES FROM THE INSIDE OF THE PLYWOOD SUPPORTS
- THE LOCATIONS OF THE SCREWS ARE SHOWN TO THE RIGHT

**NOTE: FLIP OVER AND REPEAT STEPS FOR SECOND SIDE**

## STEP FOUR: EXTERIOR LEG ATTACHMENTS

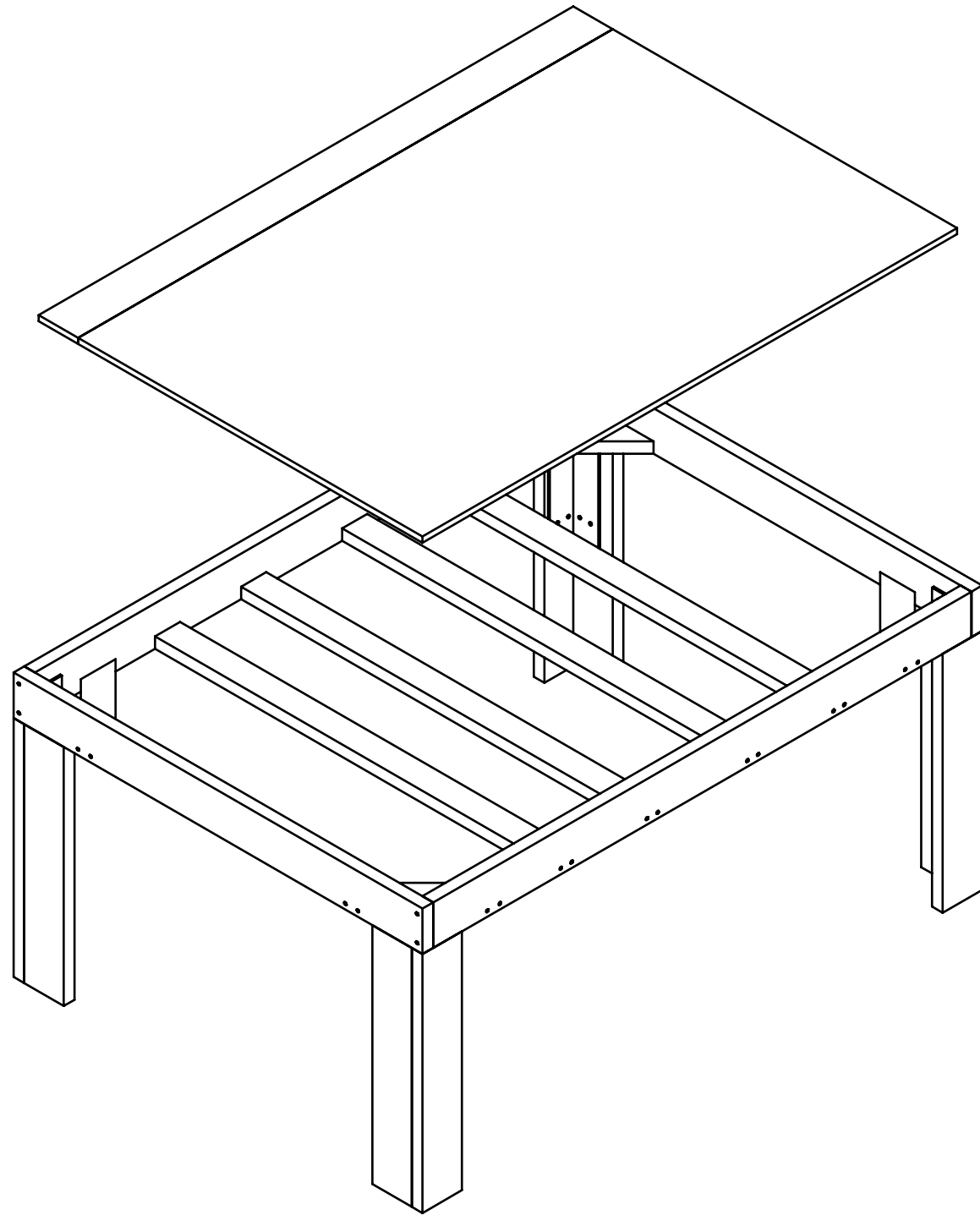

- WITH THE FRAME COMPLETED, THE PLYWOOD PIECE AND THE 1X6 BOARD SHOULD FIT INSIDE THE CREATED FRAME (NO CONSTRUCTION NEEDED)